

Cyclo Parts List

Cyclo Reducer Input Section

Single Reduction

Figure 5.9

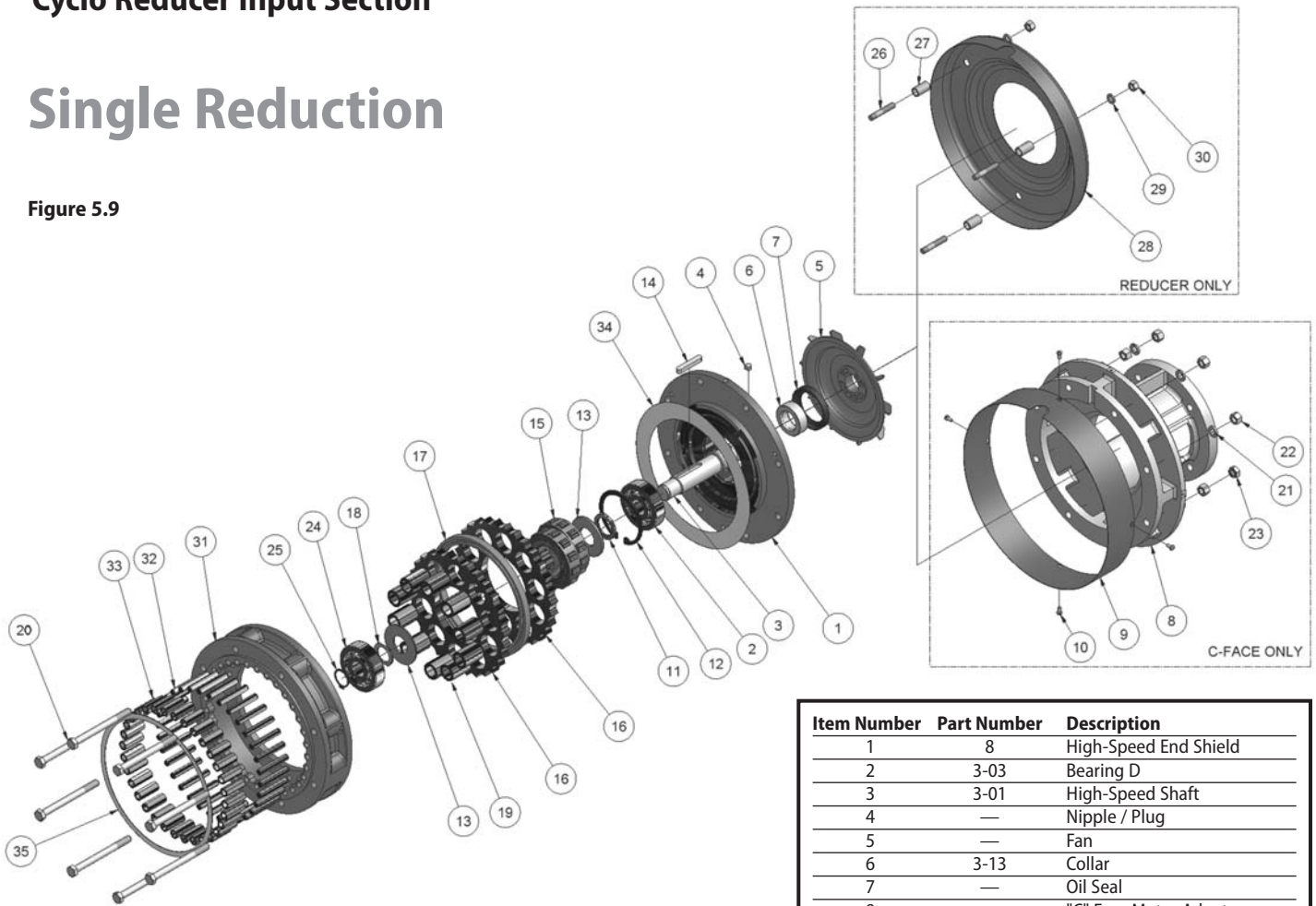

Table 5.17 Single Reduction Input Section Main Parts

| Item Number | Part Number | Description |
|-------------|-------------|--------------------------|
| 1 | 8 | High-Speed End Shield |
| 2 | 3-03 | Bearing D |
| 3 | 3-01 | High-Speed Shaft |
| 4 | — | Nipple / Plug |
| 5 | — | Fan |
| 6 | 3-13 | Collar |
| 7 | — | Oil Seal |
| 8 | — | "C" Face Motor Adapter |
| 9 | — | Fan Shroud |
| 10 | — | Shroud Bolts/Screws |
| 11 | 3-08 | Spacer |
| 12 | 3-11 | Snap Ring |
| 13 | — | Endplate |
| 14 | 3-05 | Eccentric Key |
| 15 | 3-04 | Eccentric Cam Assembly |
| 16 | 2-04 | Cycloid Discs |
| 17 | 2-05 | Disc Spacer |
| 18 | 3-09 | Spacer |
| 19 | — | Slow Speed Shaft Rollers |
| 20 | — | Housing Bolts |
| 21 | — | Washers |
| 22 | — | Nuts |
| 23 | — | Locknut |
| 24 | 3-02 | Bearing C |
| 25 | 3-10 | Snap Ring |
| 26 | — | Tap-End Stud |
| 27 | — | Fan Spacer |
| 28 | — | Fan Cover |
| 29 | — | Washers |
| 30 | — | Nuts |
| 31 | 2-01 | Ring Gear Housing |
| 32 | 2-02 | Ring Gear Pins |
| 33 | 2-03 | Ring Gear Rollers |
| 34 | — | Gasket* |
| 35 | — | Gasket* |

*Supplied as a set only

Cyclo Parts List continued

Cyclo Reducer Input Section

Double Reduction

Figure 5.10

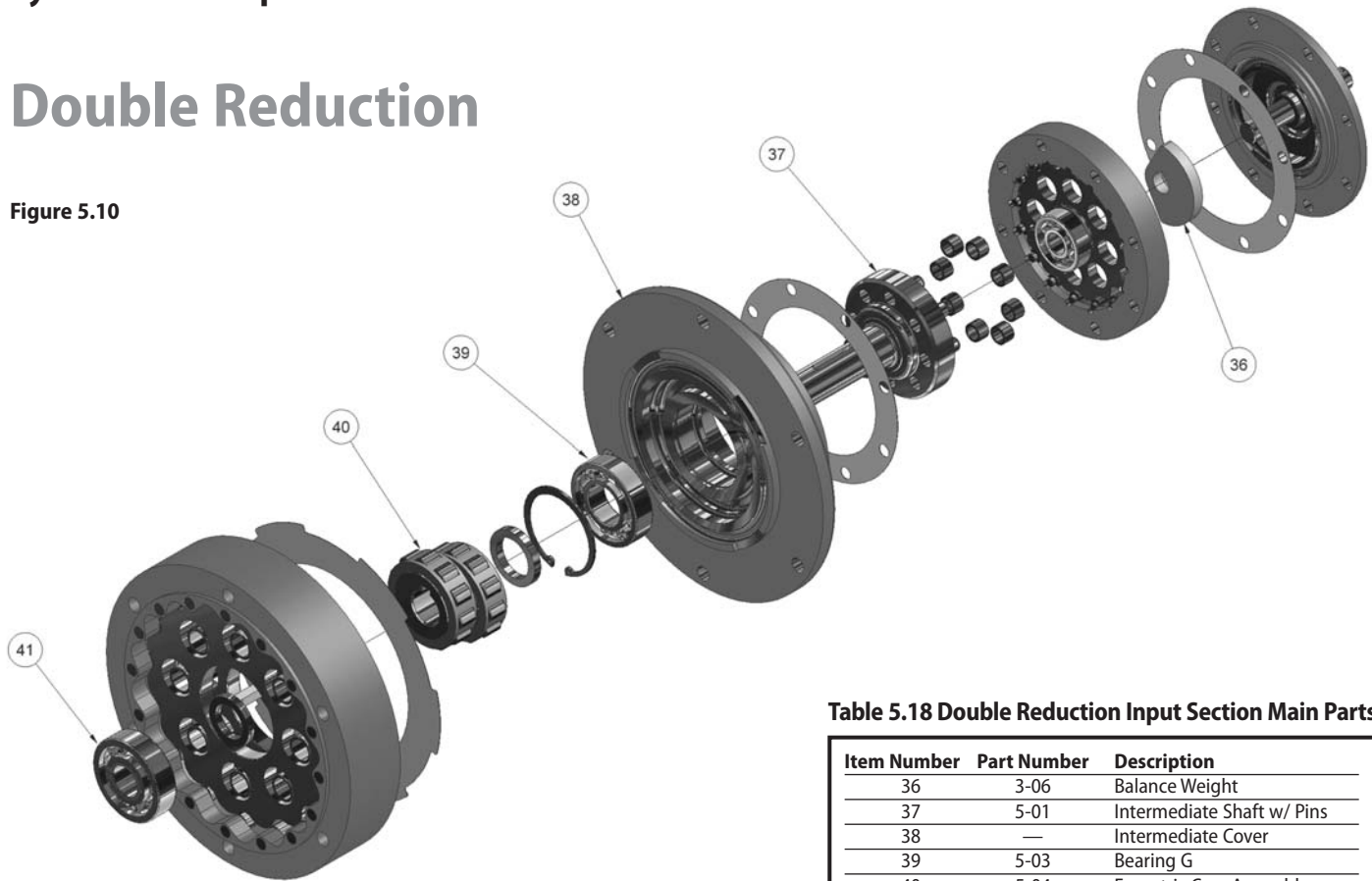

Table 5.18 Double Reduction Input Section Main Parts

| Item Number | Part Number | Description |
|-------------|-------------|----------------------------|
| 36 | 3-06 | Balance Weight |
| 37 | 5-01 | Intermediate Shaft w/ Pins |
| 38 | — | Intermediate Cover |
| 39 | 5-03 | Bearing G |
| 40 | 5-04 | Eccentric Cam Assembly |
| 41 | 5-02 | Bearing F |

NOTE: The parts listed are a general representation of the components found in a single and double reduction Cyclo.

Specific units may or may not contain all shown here.

Please consult the factory for specific part questions.